

# Crescendo®, 120V 60Hz

Height: 31.3" Width: 14.1" Depth: 18.9"  
(79.5cm) (35.8cm) (48.0cm)



- Precision burrs are used for clean-cut milling of the beans and assurance of superior grounds production
- Engineered with three powder hoppers: two 3.3 lb (1.5 kg) hoppers for larger demand flavors and one 2.2 lb (1 kg) hopper for an additional selection
- Prominent 2.2 lb (1 kg) bean hopper allows for full visibility of fresh whole beans
- Spent pucks are automatically deposited in a 70-puck capacity holding bin: optionally, spent pucks may be eliminated via a through-counter chute
- Touchpad features two programmable portion sizes of 8 to 12 oz (230 to 350 ml) each, up to nine beverage choices, plus hot water
- Compact footprint
- Bright, high-visibility nozzle defines the 5.5" (140.5 mm) height of the dispense area
- 9 bar pressure assures optimal extraction and, coupled with a variable brew group, produces superb single or double shots, each finished with a handsome crema
- Adjustable speed auger motors deliver reliable performance, routinely fulfilling ingredient portioning requirements
- Designed, engineered and assembled by BUNN in the USA
- PROP 65 Warning Decal included in packaging with equipment

Agency:



## Specifications

**Product #:** 44300.0201

**Water Access:** Plumbed

**Finish:** Stainless/Black

## Additional Features

Hot Water Button

## Electrical & Capacity

Volts*	Amps	Watts	Cord Attached	Plug Type	8oz cups/hr 236ml cups/hr	Input H <sub>2</sub> O Temp.	Phase	# Wires plus Ground	Hertz
120	11.0	1300	Yes	NEMA 5-15P	40	60°F (15.5°C)	1	2	60

\*When a BUNN is machine rated 120/208-240V, 120/208V or 120/240V, the higher voltage is the supply voltage needed to power the machine. The 120V is there to supply power to some components rated 120V in the machine, but it is not the supply voltage and would not power the machine if the machine is marked with the before mentioned ratings.

## Plumbing Requirements

PSI	kPa	Fitting Supplied	Water Flow Required (GPM)
20-90	138-621	3/4" BSPP	0.50

## CAD Drawings

2D	Revit	KLC
●		

**WARNING:** This product can expose you to chemicals including Bisphenol A (BPA), which is known to the State of California to cause birth defects or other reproductive harm. For more information go to [www.P65Warnings.ca.gov](http://www.P65Warnings.ca.gov)



BUNN® reserves the right to change specifications and product design without notice. Such revisions do not entitle the buyer to corresponding changes, improvements, additions or replacements for previously purchased equipment. For most current specifications and other info visit [bunn.com](http://bunn.com).

Last Updated:  
08/06/2025

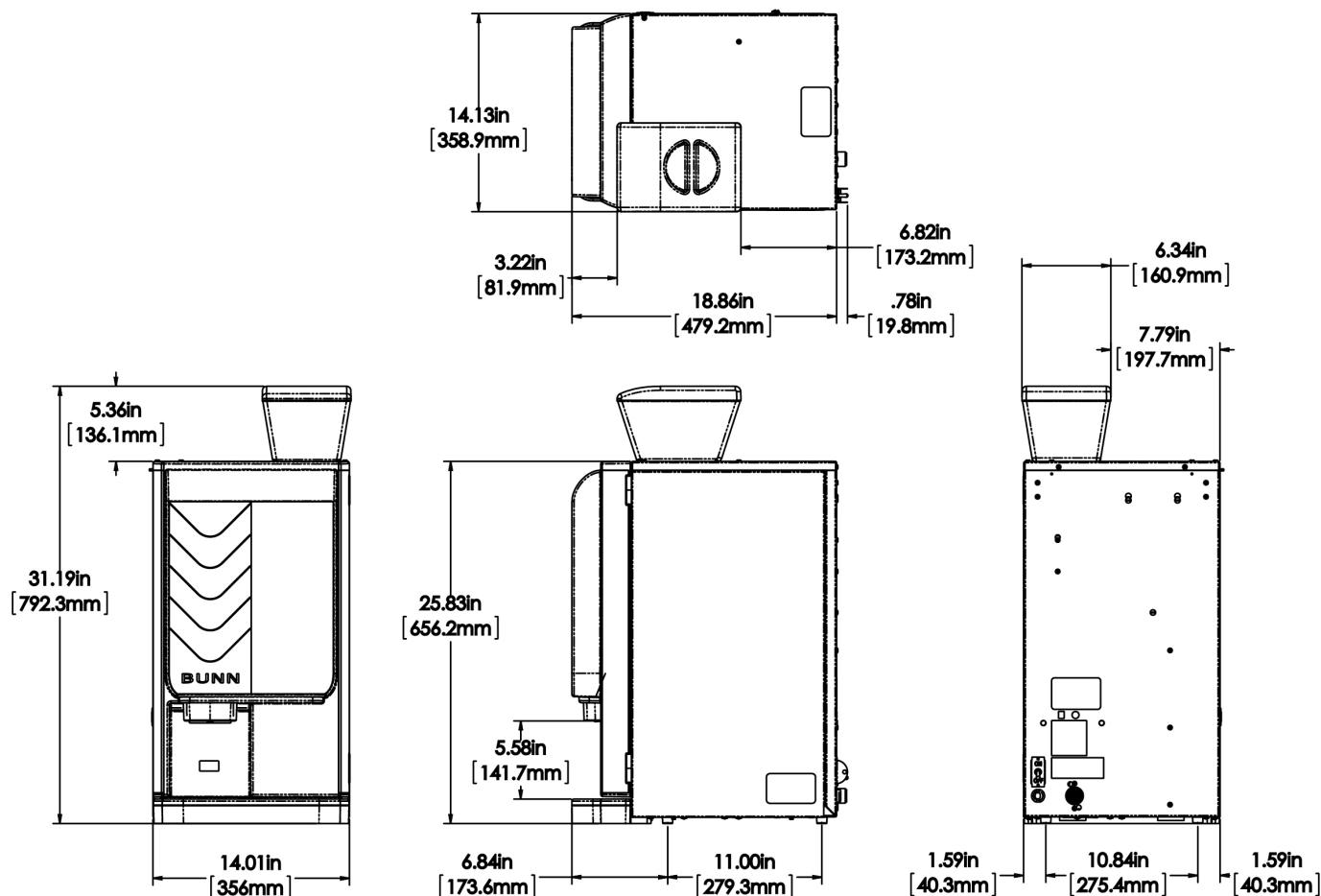









Unit				Shipping				
	Height	Width	Depth	Height	Width	Depth	Weight	Volume
English	31.3 in.	14.1 in.	18.9 in.	38.0 in.	17.9 in.	25.9 in.	101.000 lbs	10.171 ft³
Metric	79.5 cm	35.8 cm	48.0 cm	96.5 cm	45.4 cm	65.7 cm	45.814 kgs	0.288 m³

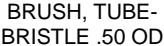

BUNN® reserves the right to change specifications and product design without notice. Such revisions do not entitle the buyer to corresponding changes, improvements, additions or replacements for previously purchased equipment. For most current specifications and other info visit [bunn.com](http://bunn.com).

Last Updated:  
08/06/2025

Related Products & Accessories:Crescendo®, 120V 60Hz(44300.0201)

 <p>BRUSH, TUBE-NYL BRISTLE .25 OD</p> <p>Product #: 26367.0000</p>	 <p>WATER FILTER, EQHP-10L</p> <p>Product #: 39000.0001<sup>3</sup></p>	 <p>BRUSH, TUBE- BRISTLE .50 OD</p> <p>Product #: 49827.0000</p>	 <p>TABLET, CLEANING 32TABS/BOX CRESCENDO</p> <p>Product #: 55605.0000</p>	 <p>SYSTEM, WQ-55(2)5L</p> <p>Product #: 56000.0001<sup>1</sup></p>
 <p>SYSTEM, WEQ-10(1.5)5L</p> <p>Product #: 56000.0024<sup>1</sup></p>	 <p>CARTRIDGE, WQ-55(2)5L</p> <p>Product #: 56000.0101<sup>1</sup></p>	 <p>CARTRIDGE, WEQ-10 (1.5)5L</p> <p>Product #: 56000.0121<sup>1</sup></p>		

<sup>1</sup>NSF Certified <sup>2</sup>NSF Certified with spec sheet model listed <sup>3</sup>NSF Certified under Solventum Purification <sup>4</sup>NSF Certified under Mavea LLC <sup>5</sup>NSF Certified under Zojirushi <sup>6</sup>NSF Certified under Qins Inc <sup>7</sup>NSF COMPONENT Certified



## Serving & Holding Options: Crescendo®, 120V 60Hz(44300.0201)

\*Serving and Holding selections are currently unavailable. Please contact your sales representative to find out more information.\*

<sup>1</sup>NSF Certified <sup>2</sup>NSF Certified with spec sheet model listed <sup>3</sup>NSF Certified under Solventum Purification <sup>4</sup>NSF Certified under Mavea LLC <sup>5</sup>NSF Certified under Zojirushi <sup>6</sup>NSF Certified under Qins Inc <sup>7</sup>NSF COMPONENT Certified



BUNN® reserves the right to change specifications and product design without notice. Such revisions do not entitle the buyer to corresponding changes, improvements, additions or replacements for previously purchased equipment. For most current specifications and other info visit [bunn.com](http://bunn.com).

Last Updated:  
08/06/2025